



UJEEDDO: HESHIIS KU SAABSAN KALA GADASHO DHUL BANAAN "LEHNA SHARCI MUNICIPALLE AH"

Maanta oo ay tariikhdu tahay 16/01/2025 Anigoo ah Dr. Maxamed C/laahi Maxamed "Max'ed Nootayo", Lehna Nootaayo Tayo, Xafiisna ku leh Wadada Koowaad ee Suuqa Bakaaraha Dhinaca Galbeed ee Daarta Maalin Taajir ee Magaalada Muqdisho, Waxaa xafiiskeyga iigu yimid ayagoo heshiis ah, Mudanayaasha hoos Ku Xusan:-

ISKA IIBIYE:- MOHAMED MAALIM HASSAN, Somali ah Hooyo: Nadiifo Macalin Cabdulle, Ku Dhashay: MUQDISHO Sanadkii: 15/02/1990 Degan Kaaraan, Sita Somali Passport:- P01014457 - waaxda Socdaalka iyo Jinsiyadaha Soomaliya.	IIBSADE:- AXMED CALI MAXAMUUD , Somali ah, Hooyo: FAADUMO MAXAMUUD MAXAMED, Ku Dhashay: MUQDISHO Sanadkii: 03/03/1983, Degan Kaaraan
TILMAAMAHA DHULKA LA KALA IIBSANAAYO Dhul Banaan oo Ku yaal: Muqdisho , Degmada: (Yaaqshiid) , Cabirka: (40X15)-M , Loto No: 849-850/PZ W.M.L: [16451/2020] Tr:24/09/2020 kana Soo Baxay Nootaayaha Muqdisho, Uuna Saxiixay Dr. Maxamed Cali Nuur (Socdal)	SOOHDINTA DHULKA Bari: dhul dad, Koonfur: Jid , Galbeed: dhul dad, Waqooyi: Jid QIIMAHA DHULKA: USD \$20,000 (Labaatan Kun oo Doolarka Mareykanka ah).
ASALKII HORE: MAXAMED XUSEEN COSOBLE RL:- 82629, Tr. 08/09/2012, B/B:76/29/2012, Tr.8/9/2012, Kana Soo Wada Baxeen D/H ee Muqdisho Cabirka (40X120)-M Loto No 845-860-PZ	

B - Aniga oo ah MOHAMED MAALIM HASSAN, Waxaan qoraalkaan ku cadaynayaa aniga oo maskaxda iyo Caqligaba ka fiyoow cid I qasabtayna Aysan Jirin in aan ka iibiyey kuna wareejiyey **AXMED CALI MAXAMUUD** Dhulkayga banaan oo tilmaamihiisu sare ku xusan yahay, Waxaan kale oo aan Cadaynayaa in dhulkaan uu ka madax banaan yihiin rahan, xuquuq ama sheegasho cid kale, iyo wax kasta oo horjoogsan kara heshiiskan, Sidaas daraadeed Wixii Ceebaal ah, ee Ka Yimaada Dhulkaan Sida Danguud, Dukuminti Ka Horeeyey dukumintigaan, dukuminti been abuur ah ama Duris Sharci iyo Wixii La Mid ah aniga ayaa Mas'uul Ka ah , Waxaan Kale oo Cadeynayaa in aan Qaatay Dhamaan Lacagta Sare Ku Xusan.

T- Anigoo ah AXMED CALI MAXAMUUD Ahna iibsadaha dhulkaan, Waxaan Caddeynayaa In aan Ka Gudoomay Iska iibiyaha Milkiyada dhulkaan, Kuna qancay Heshiiskan

J- Anaga oo Kala ah 1- MOHAMED HASSAN MOHAMUD & 2- ABDI ALI HASSAN Waxaan Cadaynayaa in aan Markhaatiyaal iyo Goob Joogba Ka nahay Beccaan.

SAXIIXA ISKA IIBIYAH DHULKA

MOHAMED MAALIM HASSAN

Mohamed Maalim Hassan

SAXIIXA IIBSADAHA DHULKA

AXMED CALI MAXAMUUD

Axmed Cali Maxamuud

SAXIIXA MARKHAATIYAASHA

1- MOHAMED HASSAN MOHAMUD

Mohamed Hassan Mohamud

2- ABDI ALI HASSAN

Abdi Ali Hassan

(XAFIISKA NOOTAAYAHA)

REP. 1338/T.P.N/25, Tr. 16/01/2025, Muqdisho, Anigoo ah Nootaayaha Tayo:- **Dr. Maxamed C/laahi Maxamed "Max'ed Nootayo"**, Waxaan Sugayaa in Saxiixyada Kor Ku Xusan ay yihiin Saxiixyadii Runta ahaa ee **1- MOHAMED MAALIM HASSAN** Ahna (Iska iibiye), **2- AXMED CALI MAXAMUUD** Ahna (Iibsade) iyo Markhaatiyaasha, Waxaan Laga Wada Saxiixay ayagoo Raali ah, Caafimaad Qaba, Maskaxdoodu Taam tahay, Cid Khasabtayna ayaa dib Markii Loo Aqriyey Beccaan, Waxaa Lagu Qoray Diiwaanka Guud ee Nootaayada Waxaan ku Kooxda Nuqul.

By:TayoPN

NOOTAAYAHA

Dr. Maxamed C/laahi Maxamed "Max'ed Nootayo"



Handwritten notes and signatures at the bottom right.

Computer ID

00106593



LAMBAR BOONADA 001-00000132953

LACAGTA:

50.00



**DOWLADDA HOOSE EE MUQDISHO
MUNICIPALITY OF MOGADISHU**

WARQADDA DIIWAAN GELINTA KALA WAREEJINTA DHULKA

Date Issued 21-Jan -2025

Dowladda Hoose ee Muqdisho waxey diiwaangalinasay Becca lambarkiisu yahay

Taariikh

Booska lotto no Cabirkisuna yahay

Kuna yaala Degmada/Deegaanka

Kana soo baxay nootayada

Kuna wareegay

Kana wareegay

Asalka: magaca loo cabiray:



Duqa Magaalada ee Muqdisho

Mayor of Mogadishu

Maxamed Axmed Amiir



UJEEDO:- HESHIIS KALA GADASHO DHUL BANAAN

L.16451/2020

Tr.24/09/2020

Sanadka Labada kun iyo labaatanka Maalinta 24-ka Sebteembar 2020 (24/09/2020) Anigoo ah Dr. Maxamed Cali Nuur (Socdaal) Xafiiska Nootaayaha Muqdisho, Xafiisna ku leh Wadada H/wadaag ee Degmada H/wadaag inta u dhaxeysa Shirkadda Isgaarsiinta Hormuud iyo Masjidka Abuu Hureyra, waxaa iigu yimid iyagoo heshiis ah dadka kala ah:

1) Cabdulqaadir Maxamed Kadiye Sabriye ina Salaado Maxamed ku dhashay Xamar sanadkii 1961 degan Xamar lehna Baasaboor No.HB206696/Canada ahna Iskagade.....2) Maxamed Maalim Xasan Cali ina Nadiifo Macalin Cabdulle ku dhashay Xamar sanadkii 1990 degan dalka Kenya (Nairobi) ahna iibsade, uuna u saxiixay Cumar Cabdi BarreUgu horeyn dadkaasi waxay i weydiisteen in aan u kala qoro heshiis ku saabsan kalagadasho dhul ku yaal degmada **Yaaqshiid** lehna W.M.L.06123/2013 Tr.07/10/2013 kana soo baxday Xafiiska Nootaayaha Muqdisho uuna saxiixay Dr. Maxamed Cali Nuur **Lotto L.849, 850/PZ**, cabirkiisuna dhan yahay **(40X15M)** ahna dhul banaan soohdimihiisuna kala yihiin: **Koofur jid**, **Waqooyi jid**, **Bari dhul dad**, **Koofur Galbeed dhul dad**, Cabdulqaadir Maxamed Kadiye Sabriye wuxuu qoraalkaan ku cadeynayaa in uu ka iibiyey kuna wareejiyey Maxamed Maalim Xasan Cali dhulkiisa banaan oo ku yaal degmada **Yaaqshiid** cabirkiisuna dhan yahay **(40X15M)**, **Lotto L. 849, 850/PZ** **Koofur jid**, **Waqooyi jid**, **inta kalana dhul dad**, sidaa darteed milkiyadai dhulkaas waxay ku wareegtay ninka iibsaday oo ah: **MAXAMED MAALIM XASAN CALI**, Cabdulqaadir Maxamed Kadiye Sabriye wuxuu kaloo qoraalkaan ku cadeynayaa in dhulkaasi uu iska iibiyey ka madax banaan yahay rahan iyo sheegasho dad kale waxayna ku heshiiyeen oo ku kala iibsadeen lacag dhan **U.S.\$25,000/=**(LABAATAN IYO SHAN KUN OO DOOLAR AMEERIKAAN AH) oo gacanta laga saaray iskagadaha, wixii ka yimaada milkiyada dhulkaasi oo sheegasho dad kale ah waxaa mas'uul ka ah iskagadaha wixii aan ku xusneyn halkaan waxaa loo raacayaa sida uu qabo sharciga Jamhuuriyadda Soomaliya, heshiiskaasina sidaasi ayuu ku dhamaaday markii ay aqristeen dhinacyadu oo ay wada fahmeen ayeyna halkaan hoose wada saxiixeen.

F.G. Dhulkaan oo leh Nullo oste **L.069204** /2020 Tr. **26/09/** /2020 kana soo baxday wasaarada maaliyada waaxda canshuuraha beriga

Iskagade: Cabdulqaadir Maxamed Kadiye Sabriye Cabdulqasim Maxamed

Wakiil u saxiixe: Cumar Cabdi Barre Cumar Abubakar

Marag: Axmed Cali Maxamuud AHMED ALI MOTA MUD

" : Maxamed Abuukar Maxamuud (Deeqow) Mohamed Abubakar Mahamuud

" : Cabdiraxmaan Cali Maxamuud Cabdiraxmaan Cali Maxamed

Waa la duwanaa

Waa na la magac

Waa la joojiyey

Dr. Maxamed Cali Nuur (Socdaal)





Iskagade,

Cabdulqaadir Maxamed Kadiye Sabriye



Wakiil u saxiixe

Cumar Cabdi Barre



iskagade iyo Wakiil u saxiixe



Marag

Axmed Cali Maxamuud



Marag

Maxamed Abuukar Maxamuud



Marag

Cabdiraxmaan Cali Maxamuud



Markaatiyaal

Bee
R.1338/T.P.N/25 T.16/01/25
40X15.M
L.849-850-P2





JAMHUURIYADDA FEDERAALKA SOOMALIYA
Wasaaradda Maaliyadda
Waaxda Canshuuraha Barriga
WARQADDA RUQSADA GADIDDA HANTIDA

TIRS# : 2020 - TRS-069204



Waaxda Canshuuraha Barriga ee Wasaaradda Maaliyadda Waxey Ruqseysay Wareejinta Hantida ay faahfaahinteedu hoos ku xusan tahay:

NOOCA HANTIDA MA GUURTADA AH:

DHUL BANAAN

LOT NUMBER

849, 850/PZ

TITLE DEED NO

W.M.L.06123/2013 TR.07/10/2013

DEGMADA

Yaaqshiid

CABIRKA

40X15M

CIDDA WAREEJINEYSA

C/QAADIR MAXAMED KADIYE

CIDDA LAGU WAREEJINAYO

MAXAMED MAALIM XASAN

NOTARY

SOCDAAL

NOTARY REF

16451/2020

QIIMAHA LAGU KALA GATAY

\$25,000.00

Taariikda la bixiyey:

26/09/2020 00:00:00



TRS-
069204

Waaxda Cansuuraha Barriga



Computer ID
0018929

LAMBAR BOONADA 001-0000040741
LACAGTA: 50.00



DOWLADDA HOOSE EE MUQDISHO
MUNICIPALITY OF MOGADISHU

WARAQAADDA DIIWAANGALINTA KALA WAREEJINTA DHULKA

Date Issued 27-Sep-2020

Dowladda Hoose ee Muqdisho waxey diiwaangalinasay Becca lambarkiisu yahay

16451

Taariikh

27-Sep-2020

Booska lotto no

849-850-PZ

Cabirkisuna yaha

40X15-M

Kuna yaala Degmada

Yaaqshiid

Kana soo baxay Nootayda

Maxamed Cali Nuur (Socdaal)

Kuna wareegay

MAXAMED MAALIM XASAN CALI

Kana wareegay

C/QAADIR MAXAMED KADIYE SABRIYE

Asalka: Magaca loo cabiray:

MAXAMED XUSEEN COSOBLE. RL: 82629.Tr: 8/9/2012.SABARLOG:
BL.76/BL.29/2012.Tr: 9/9/2012.D/H/X.CABIR. 40X120-M.LOOTO: 845-860-PZ



Duqa Magaalada ee Muqdisho
Mayor of Mogadishu

Cumar Maxamuud Maxamed

Cumar Maxamuud Maxamed





XAFIISKA NOOTAAYAHA MUQDISHO
PUBLIC NOTARY

UJEEDO:- HESHIIS KALA GADASHO DHUL BANAAN

L.06123/2013

Tr.07/10/2013

Sanadka Labada kun Sedex iyo Tobanka Maalinta 7-da Octoobar 2013 (07/10/2013) Anigoo ah Dr. Maxamed Cali Nuur Xafiiska Nootaayaha Muqdisho, Xafiisna ku leh Wadada H/wadaag ee Degmada H/wadaag inta u dhaxeysa Shirkadda Isgaarsiinta Telcom Somaliya iyo Shirkadda Xawaalada Dahabshiil waxaa iigu yimid iyagoo heshiis ah dadka kala ah:

1)Maxamed Xuseen Cosoble Weheliye (Abgaalow) ina Jimco Axmed Bahdoon ku dhashay Xaradheere sanadkii 1959 degan Degmada Yaaqshiid lehna Baasaboar No.P00110404/Somaliya, ahna iskagade....2)Cabdulqaadir Maxamed Kadiye Sabriye ina Salaado Maxamed ku dhashay Xaradheere sanadkii 1962 degan Kanada ahna iibsade, uuna u saxiixay Sayid-Cumar Maxamed Kadiye.....Ugu horeyn dadkaasi waxay i weydiisteen in aan u kala qoro heshiis ku saabsan alagadasho dhul ku yaal degmada Yaaqshiid lehna W.L.Q.82629 Tr.8/9/2012 W.L.DH.B/B/76/29/2012 Tr.9/9/2012 kana soo baxday D.H.X. Lotto L.849, 850, 851, 852/PZ, cabirkiisuna dhan yahay (40X30M) ahna dhul banaan soohdimihiisuna kala yihiin Waqooyi jid=====, Koofur jid=====, Galbeed dhul dad, Bari dhul dad, Maxamed Xuseen Cosoble Weheliye (Abgaalow) wuxuu qoraalkaan ku cadeynayaa in uu ka iibiyey kuna wareejiyey Cabdulqaadir Maxamed Kadiye Sabriye dhulkiisa banaan oo ku yaal degmada Yaaqshiid cabirkiisuna dhan yahay (40X30M), Lotto L.849, 850, 851, 852/PZ, Waqooyi jid, Koofur jid, intakalana dhul dad, sidaa darteed milkiyadii dhulkaas waxay ku wareegtay ninka iibsaday oo ah: CABDULQAADIR MAXAMED KADIYE SABRIYE, Maxamed Xuseen Cosoble Weheliye (Abgaalow) wuxuu kaloo qoraalkaan ku cadeynayaa in dhulkaasi uu iska iibiyey ka madax banaan yahay rahan iyo sheegasho dad kale waxayna ku heshiiyeen oo ku kala iibsadeen lacag dhan U.S.\$13,450/=(TOBAN IYO SEDEX KUN AFAR BOQOL IYO KONTAN DOOLAR) oo gacanta laga saaray iskagadaha, wixii ka yimaada milkiyada dhulkaasi oo sheegasho dad kale ah waxaa mas'uul ka ah iskagadaha wixii aan ku xusneyn halkaan waxaa loo raacayaa sida uu qabo sharciga Jamhuuriyadda Soomaliya, heshiiskaasina sidaasi ayuu ku dhamaaday markii ay aqristeen dhinacyadu oo ay wada fahmeen ayeyna halkaan hoose wada saxiixeen.

Iskagade: Maxamed Xuseen Cosoble Weheliye (Abgaalow) Maxamed Xuseen Cosoble

Waliik iibsade: Sayid-Cumar Maxamed Kadiye Sayid-Cumar Maxamed Kadiye

Marag: Cabdullaahi Cali Ciid Cabdullaahi Cali Ciid

Marag: Cusmaan Axmed Xuseen Cusmaan Axmed Xuseen

NOOTAAYAHA
Dr. Maxamed Cali Nuur

ORIGINAL

RepN.16451/20

Tr24/9/20

40X15

lotto N 849, 850-PZ

RepN16452/20

Tr24/9/20

40X15

lotto N 851, 852-PZ



**DAWLADDA HOOSE EE MUQDISHO
WAAXDA DHULKA**

No.: 82629

Soo Gelidda Warqadda

Tirsi

Taariikh

82629

9-9-2012

DAWLADDA HOOSE



MUQDISHO

Bollettario No.:

Bolletta No.:

Sannadka

76

29

2012

WARQADDA LAHAANSHAHA DHULKA

Mud / Mar:

Maxied Xuseen Cosoble

Og.: Tal. Ciidaanka Boliska Dawladda Hoose Muqdisho

- Xamar.

Mudanaha / Marwada kor ku qoran waxaa loo oggolaady inuu / iney dhisto Cariish, Baraako ama

Guri Dhagax ah

40 X 120

oo uu ka dhiso cad dhul ah oo

le'eg

Dg Guy

kuna yaal Xaafadda

Y-shiid

Soohdintiisuna tahay

845

X. Woqooyi

X, Galbeed

X, Bari

860-P2

iyo Koofur

Warqaddaan xaq waxaad ugu leedahay muddo laba iyo toban (12) bilood ah oo maanta

Ka billaabmanta, fasax la'aan inaad dhulka dhistid.

Warqadda lacag qaabashada No.

82629

ee

8-9-2012

Muqdisho, Taariikh

9-9-2012

Agaasimaha Waaxda Dhulka

Duqa Magaalada

Rep 06122-013

to 7-10-013
20x 30m

Web. 845-11-849-PZ

Rep 06123-011

to 7-10-013
20x 30m

Web. 849-11-852-PZ

Rep 06124-013

to 7-10-013
20x 30m

Web. 851, 855-PZ

Rep 06125-013

to 7-10-013
20x 15

Web. 853-PZ

Rep 06126-013

to 7-10-013
20x 15

Web. 855-PZ



814/012
 DAWLADDA HOOSE EE MUQDISHO
 40X120 WAAXDA DHULKA: 845-860

4/012

P2

Xaashida lacag Qabashada No.: 82629

Mud / Mar. Maxamed Xuseen Cosoble

Waxaan ka qabtay Sh. So. 72001000, Leeloba Maly

iyada waase badeel wa kama

oo ah W. Q. B. B.

Muqdisho 08/09/012

B-Qofka Lacagta Bixiyay
 T-Maamulka Lacagta
 J-Nuqul ku haraya Boloogga

Maxamed Xuseen Cosoble
 Xaashida Lacag Qabashada

Rep 06122-93
fr 7-10-93
COX 30m
Liber 845 wa 848-PZ

Rep 06123-93
fr 7-10-93
COX 30m
Liber 849 wa 852-PZ

Rep 06124-93
fr 7-10-93
COX 30m
Liber 850, 856-PZ

Rep 06125-93
fr 7-10-93
COX 15
Liber 853-PZ

Rep 06126-93
fr 7-10-93
COX 15
Liber 855-PZ

Qabuura — B A R K A A L — W A D D A D A — B A R K A A L

<u>Lootha illoob</u>	//	//	Lootha illoob	//	//	Lootha illoob																																																																																																			
<u>Lootha illoob</u>	//	//	Lootha illoob	//	//																																																																																																				
<u>Lootha Shiroo</u>	<u>Lootha Bell. Nuuroo</u>	//	<u>Lootha. Bell. Nuuroo</u>	//	<u>Lootha. Bell. Nuuroo</u>																																																																																																				
120x50	//	100x40	//	//	//																																																																																																				
120x50	//	<table border="1"> <tr><td>259</td><td>260</td></tr> <tr><td>258</td><td>261</td></tr> <tr><td>257</td><td>262</td></tr> <tr><td>256</td><td>263</td></tr> <tr><td>255</td><td>264</td></tr> <tr><td>254</td><td>265</td></tr> <tr><td>253</td><td>266</td></tr> <tr><td>252</td><td>267</td></tr> <tr><td>251</td><td>268</td></tr> <tr><td>250</td><td>269</td></tr> </table>	259	260	258	261	257	262	256	263	255	264	254	265	253	266	252	267	251	268	250	269	<table border="1"> <tr><td>293</td><td>294</td></tr> <tr><td>292</td><td>295</td></tr> <tr><td>291</td><td>296</td></tr> <tr><td>290</td><td>297</td></tr> <tr><td>289</td><td>298</td></tr> <tr><td>288</td><td>299</td></tr> <tr><td>287</td><td>300</td></tr> <tr><td>286</td><td>301</td></tr> <tr><td>285</td><td>302</td></tr> <tr><td>284</td><td>303</td></tr> <tr><td>283</td><td>304</td></tr> <tr><td>282</td><td>305</td></tr> <tr><td>281</td><td>306</td></tr> <tr><td>280</td><td>307</td></tr> </table>	293	294	292	295	291	296	290	297	289	298	288	299	287	300	286	301	285	302	284	303	283	304	282	305	281	306	280	307	<table border="1"> <tr><td>825</td><td>826</td></tr> <tr><td>823</td><td>824</td></tr> <tr><td>821</td><td>822</td></tr> <tr><td>819</td><td>820</td></tr> <tr><td>817</td><td>818</td></tr> <tr><td>815</td><td>816</td></tr> <tr><td>813</td><td>814</td></tr> <tr><td>811</td><td>812</td></tr> </table>	825	826	823	824	821	822	819	820	817	818	815	816	813	814	811	812	<table border="1"> <tr><td>859</td><td>860</td></tr> <tr><td>857</td><td>858</td></tr> <tr><td>855</td><td>856</td></tr> <tr><td>853</td><td>854</td></tr> <tr><td>851</td><td>852</td></tr> <tr><td>849</td><td>850</td></tr> <tr><td>847</td><td>848</td></tr> <tr><td>845</td><td>846</td></tr> </table>	859	860	857	858	855	856	853	854	851	852	849	850	847	848	845	846																				
259	260																																																																																																								
258	261																																																																																																								
257	262																																																																																																								
256	263																																																																																																								
255	264																																																																																																								
254	265																																																																																																								
253	266																																																																																																								
252	267																																																																																																								
251	268																																																																																																								
250	269																																																																																																								
293	294																																																																																																								
292	295																																																																																																								
291	296																																																																																																								
290	297																																																																																																								
289	298																																																																																																								
288	299																																																																																																								
287	300																																																																																																								
286	301																																																																																																								
285	302																																																																																																								
284	303																																																																																																								
283	304																																																																																																								
282	305																																																																																																								
281	306																																																																																																								
280	307																																																																																																								
825	826																																																																																																								
823	824																																																																																																								
821	822																																																																																																								
819	820																																																																																																								
817	818																																																																																																								
815	816																																																																																																								
813	814																																																																																																								
811	812																																																																																																								
859	860																																																																																																								
857	858																																																																																																								
855	856																																																																																																								
853	854																																																																																																								
851	852																																																																																																								
849	850																																																																																																								
847	848																																																																																																								
845	846																																																																																																								
<u>Lootha. Shiroo</u>	//	<table border="1"> <tr><td>245</td><td>246</td></tr> <tr><td>243</td><td>244</td></tr> <tr><td>241</td><td>242</td></tr> <tr><td>239</td><td>240</td></tr> <tr><td>237</td><td>238</td></tr> <tr><td>235</td><td>236</td></tr> <tr><td>233</td><td>234</td></tr> <tr><td>231</td><td>232</td></tr> </table>	245	246	243	244	241	242	239	240	237	238	235	236	233	234	231	232	<table border="1"> <tr><td>277</td><td>278</td></tr> <tr><td>275</td><td>276</td></tr> <tr><td>273</td><td>274</td></tr> <tr><td>271</td><td>272</td></tr> <tr><td>269</td><td>270</td></tr> <tr><td>267</td><td>268</td></tr> <tr><td>265</td><td>266</td></tr> <tr><td>263</td><td>264</td></tr> </table>	277	278	275	276	273	274	271	272	269	270	267	268	265	266	263	264	<table border="1"> <tr><td>809</td><td>810</td></tr> <tr><td>807</td><td>808</td></tr> <tr><td>805</td><td>806</td></tr> <tr><td>803</td><td>804</td></tr> <tr><td>801</td><td>802</td></tr> <tr><td>799</td><td>800</td></tr> <tr><td>797</td><td>798</td></tr> <tr><td>795</td><td>796</td></tr> </table>	809	810	807	808	805	806	803	804	801	802	799	800	797	798	795	796	<table border="1"> <tr><td>843</td><td>844</td></tr> <tr><td>841</td><td>842</td></tr> <tr><td>839</td><td>840</td></tr> <tr><td>837</td><td>838</td></tr> <tr><td>835</td><td>836</td></tr> <tr><td>833</td><td>834</td></tr> <tr><td>831</td><td>832</td></tr> <tr><td>829</td><td>830</td></tr> </table>	843	844	841	842	839	840	837	838	835	836	833	834	831	832	829	830	<table border="1"> <tr><td>827</td><td>828</td></tr> <tr><td>825</td><td>826</td></tr> <tr><td>823</td><td>824</td></tr> <tr><td>821</td><td>822</td></tr> <tr><td>819</td><td>820</td></tr> <tr><td>817</td><td>818</td></tr> <tr><td>815</td><td>816</td></tr> <tr><td>813</td><td>814</td></tr> </table>	827	828	825	826	823	824	821	822	819	820	817	818	815	816	813	814	<table border="1"> <tr><td>811</td><td>810</td></tr> <tr><td>809</td><td>808</td></tr> <tr><td>807</td><td>806</td></tr> <tr><td>805</td><td>804</td></tr> <tr><td>803</td><td>802</td></tr> <tr><td>801</td><td>800</td></tr> <tr><td>799</td><td>798</td></tr> <tr><td>797</td><td>796</td></tr> <tr><td>795</td><td>794</td></tr> </table>	811	810	809	808	807	806	805	804	803	802	801	800	799	798	797	796	795	794
245	246																																																																																																								
243	244																																																																																																								
241	242																																																																																																								
239	240																																																																																																								
237	238																																																																																																								
235	236																																																																																																								
233	234																																																																																																								
231	232																																																																																																								
277	278																																																																																																								
275	276																																																																																																								
273	274																																																																																																								
271	272																																																																																																								
269	270																																																																																																								
267	268																																																																																																								
265	266																																																																																																								
263	264																																																																																																								
809	810																																																																																																								
807	808																																																																																																								
805	806																																																																																																								
803	804																																																																																																								
801	802																																																																																																								
799	800																																																																																																								
797	798																																																																																																								
795	796																																																																																																								
843	844																																																																																																								
841	842																																																																																																								
839	840																																																																																																								
837	838																																																																																																								
835	836																																																																																																								
833	834																																																																																																								
831	832																																																																																																								
829	830																																																																																																								
827	828																																																																																																								
825	826																																																																																																								
823	824																																																																																																								
821	822																																																																																																								
819	820																																																																																																								
817	818																																																																																																								
815	816																																																																																																								
813	814																																																																																																								
811	810																																																																																																								
809	808																																																																																																								
807	806																																																																																																								
805	804																																																																																																								
803	802																																																																																																								
801	800																																																																																																								
799	798																																																																																																								
797	796																																																																																																								
795	794																																																																																																								

DE G. M. D. Y. Shid
S. C. A. L. E. J. J. O. O. S.
R. O. O. N. E. P. L.

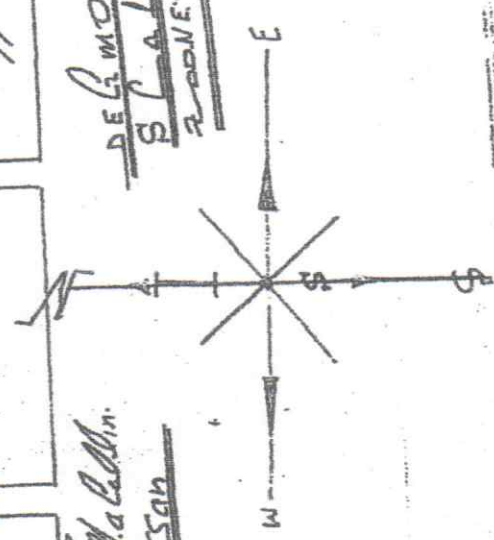

Lootha. Ma. Lellin.
Yassan

Co. M. L. M. B. L. Y. E.

Lootha. Ab. Shit. G.
L. A. D. E.

120m
W. H. S. H. O. W. A. S. H. A. N. I. Y.
 40x120m



FOOMKA BIXINTA DUKUMINTIGA

Tr. 01/02/2025

Aniga oo ah **Maxamed Cabdi Cali** waxaan halkaan ka cadeynayaa in aan ku wareejiyay **C/raxmaan Cali Maxamuud** oo ka Wakiil ah Iibsade **Axmed Cali Maxamuud** Dukumiintiga **Original+Aato** Beeca Dhulka ee **Rep No. 1338/T.P.N/25, Tr. 16/01/2025**, faah faahintiisuna tahay sidan soo socota:

Magaca Iibsadaha	Axmed Cali Maxamuud
Cabirka	40X15
Ku Yaallo	Muqdisho, Degmada Yaaqshiid
Lotto Lambar	849 -850/PZ
W.M.L	16451/2020, Tr. 24/09/2020 Ka soo baxday Nootaayo Muqdisho
Taariikhda Beeca	16/01/2025
La Socoto	<input checked="" type="checkbox"/> Wasaarada Maaliyadda <input checked="" type="checkbox"/> Dowladda Hoose

Wakiilka Iibsade: Aniga oo ah **C/raxmaan Cali Maxamuud**, Leh Tel No. **0619270299**, Degan karaan Waxaan Halkaan ka Cadeynayaa in aan ka Qaaday Xafiiska **Nootaayaha Tayo** Dukumiintiga Dhulka faah faahintiisu Sare ku cadahay uuna leeyahay **Axmed Cali Maxamuud**.



SAXIIXA DUKUMINTI BIXIYAHA

Maxamed Cabdi Cali

SAXIIXA DUKUMINTI QAADAHA

C/raxmaan Cali Maxamuud